

Austin College IDEA CENTER



**A Self-Guided
Green Tour**



**AUSTIN
COLLEGE**

A LEED Gold-Certified Science Facility

Austin College's IDEA Center is the first LEED Gold-certified facility in Grayson County.



LEED (Leadership in Energy & Environmental Design) is a green building certification system created by the U.S. Green Building Council. It recognizes best-in-class building strategies and practices.

There are four levels of certification: Certified, Silver, Gold, and Platinum. Facilities earn credits in categories of Sustainable Sites, Water Efficiency, Energy & Atmosphere, Materials & Resources, Indoor Environmental Quality, and Innovation in Design.



The building's green features set a new standard for campus sustainability while nurturing respect for knowledge and for Inquiry, Discovery, Entrepreneurship, and Access (IDEA).

Enjoy your self-guided green tour of the IDEA Center!

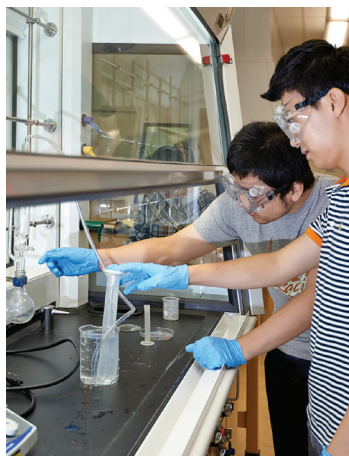

IDEA Center's Green Features



Water Efficiency



Water Capture



Green Cleaning



Energy Recovery



Thermal Comfort



Natural Lighting & Shading



Cool Roof



Green Power



Green Transportation



Living Lab



Responsibly Harvested
Materials



Regional Materials



Recycled Materials



Construction Waste



Campus Recycling



Regulated Air Flow



Low-Emitting Materials



Smart Fume Hoods

Outside

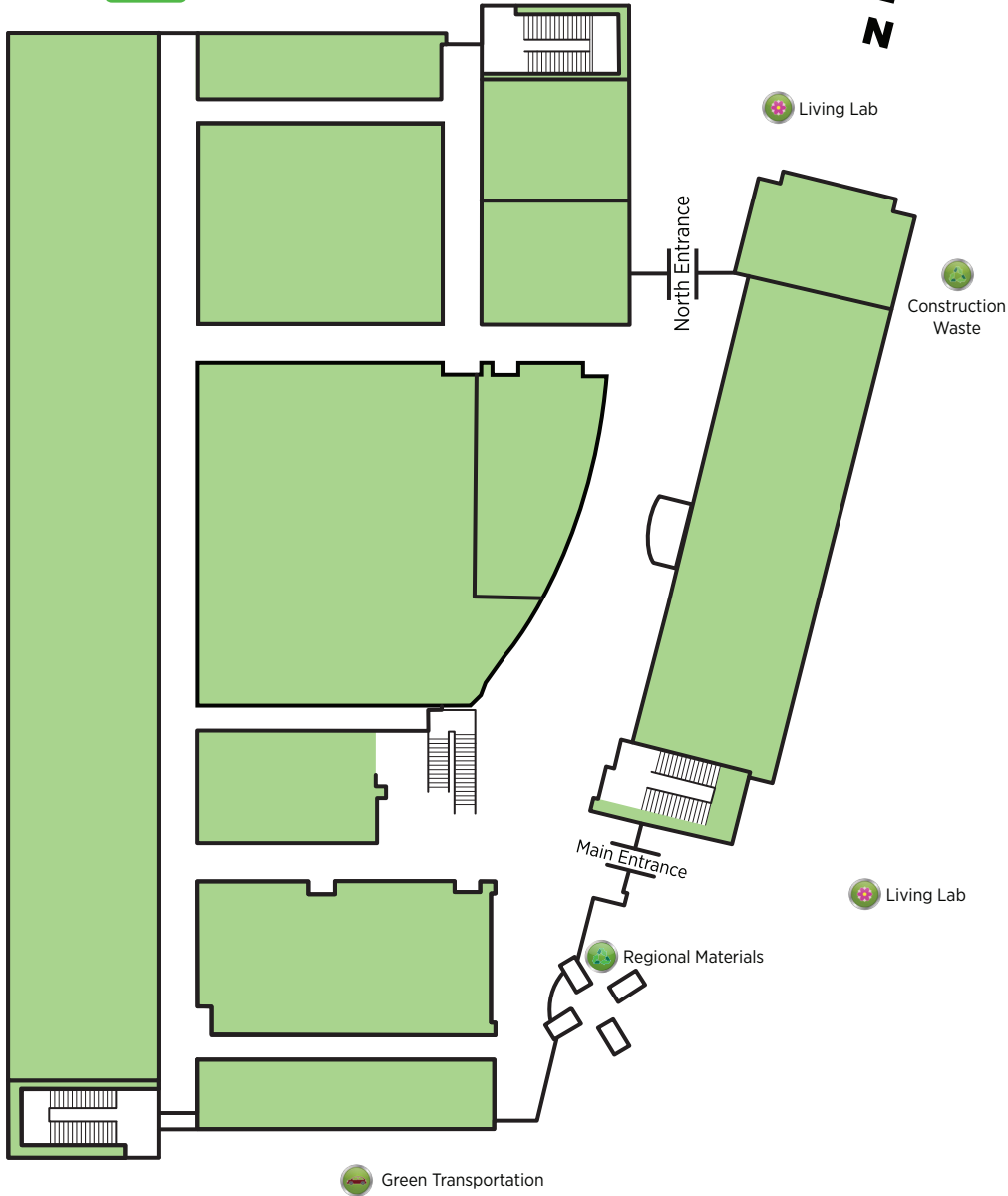
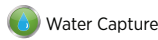
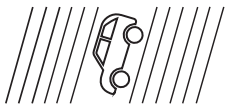

1st Floor



2nd Floor

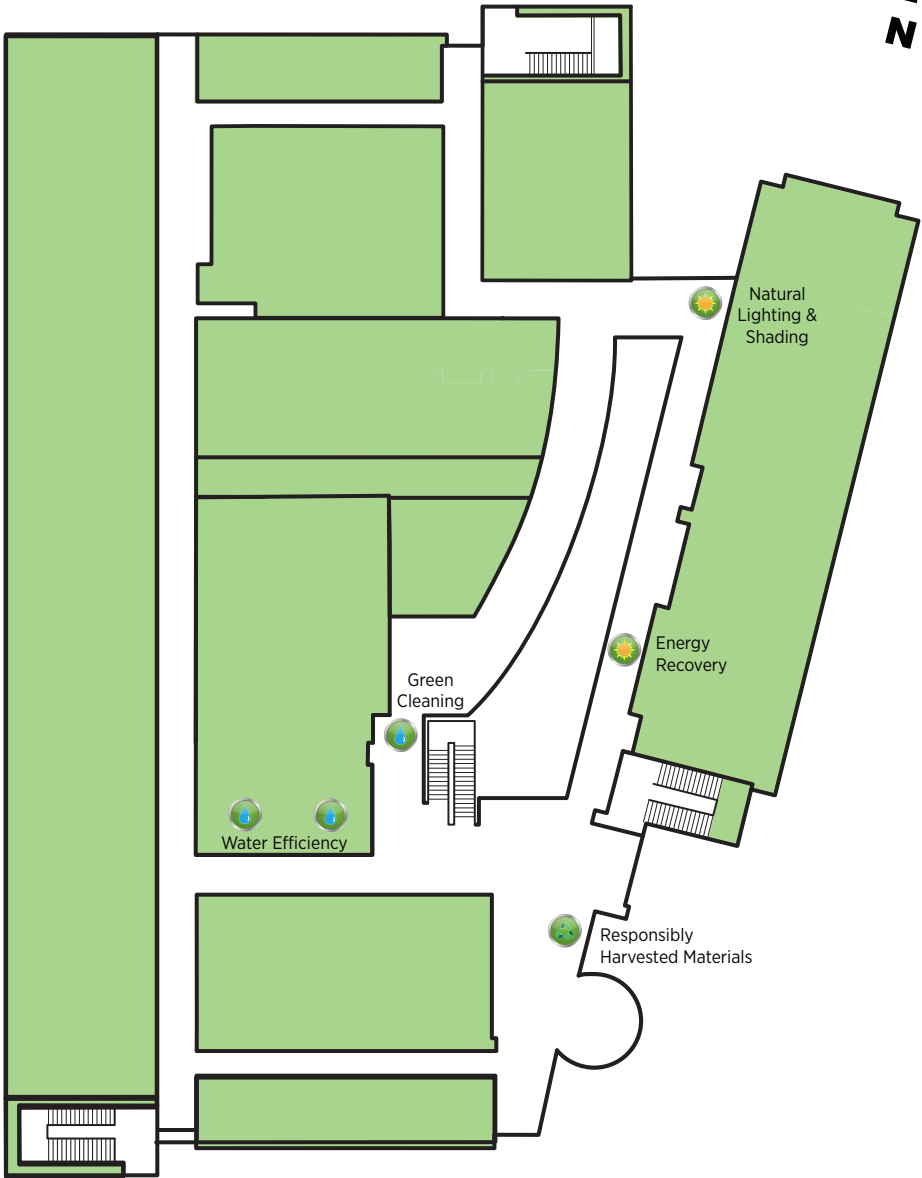

3rd Floor

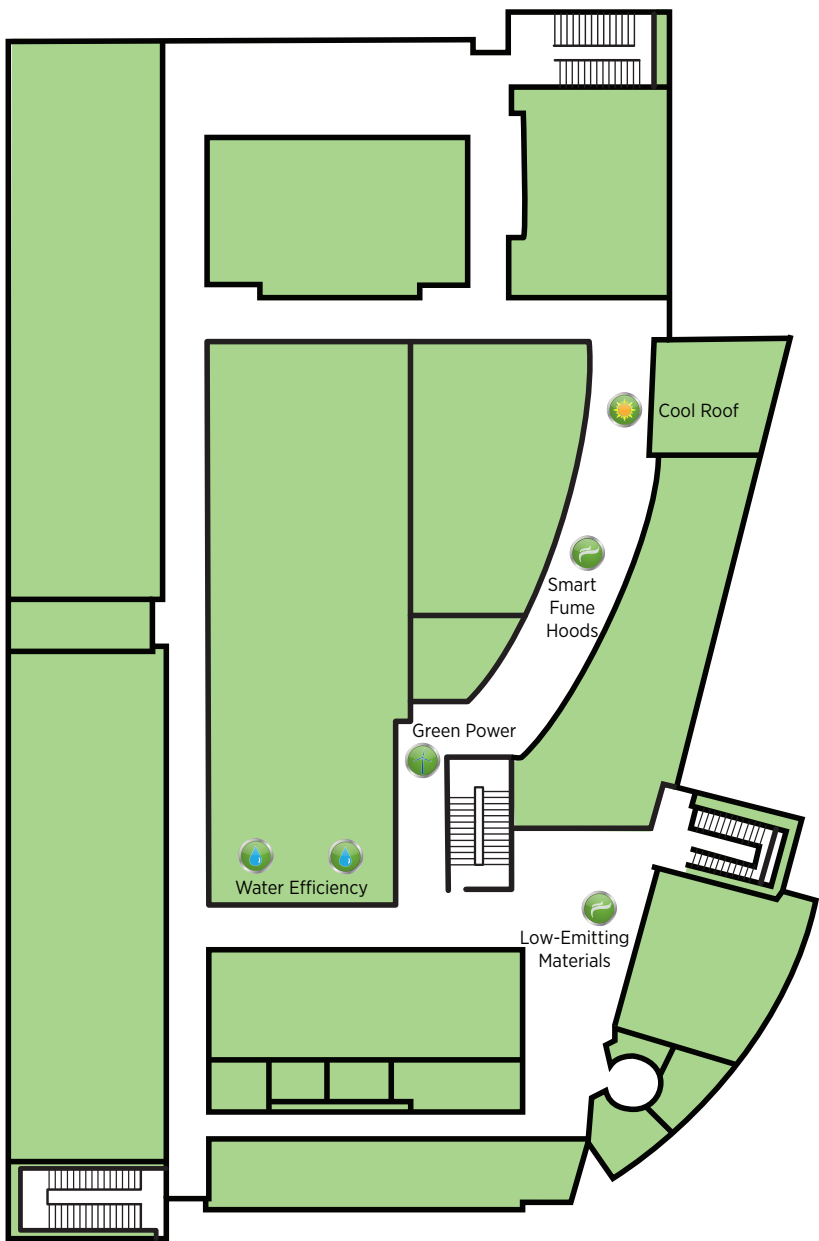

think

AUSTIN COLLEGE. THINKING GREEN.

The mission of Austin College Thinking Green is to facilitate attitudes, behaviors, policies, and technologies that promote environmental responsibility, reduce resource consumption, and minimize waste production.



- Recognition in The Princeton Review's *Guide to Green Colleges*
- GreenServe, a day of service dedicated to the environment
- AC Unplugged, a month-long electricity conservation competition among residence halls
- Student Sustainability Fund for student-initiated greening proposals
- Native tallgrass prairie restoration and outreach at Sneed Environmental Research Area
- Signatory of the American College and University Presidents' Climate Commitment to reduce campus-wide greenhouse gas emissions
- Development of the Sherman Community Garden
- Reusable to-go containers and composting of pre-consumer food waste in the dining hall

For more information, please visit www.austincollege.edu/thinking-green